

HD5 Squaring Guide

Squaring the Cradle to the Bed

1. Remove the aluminum clamp

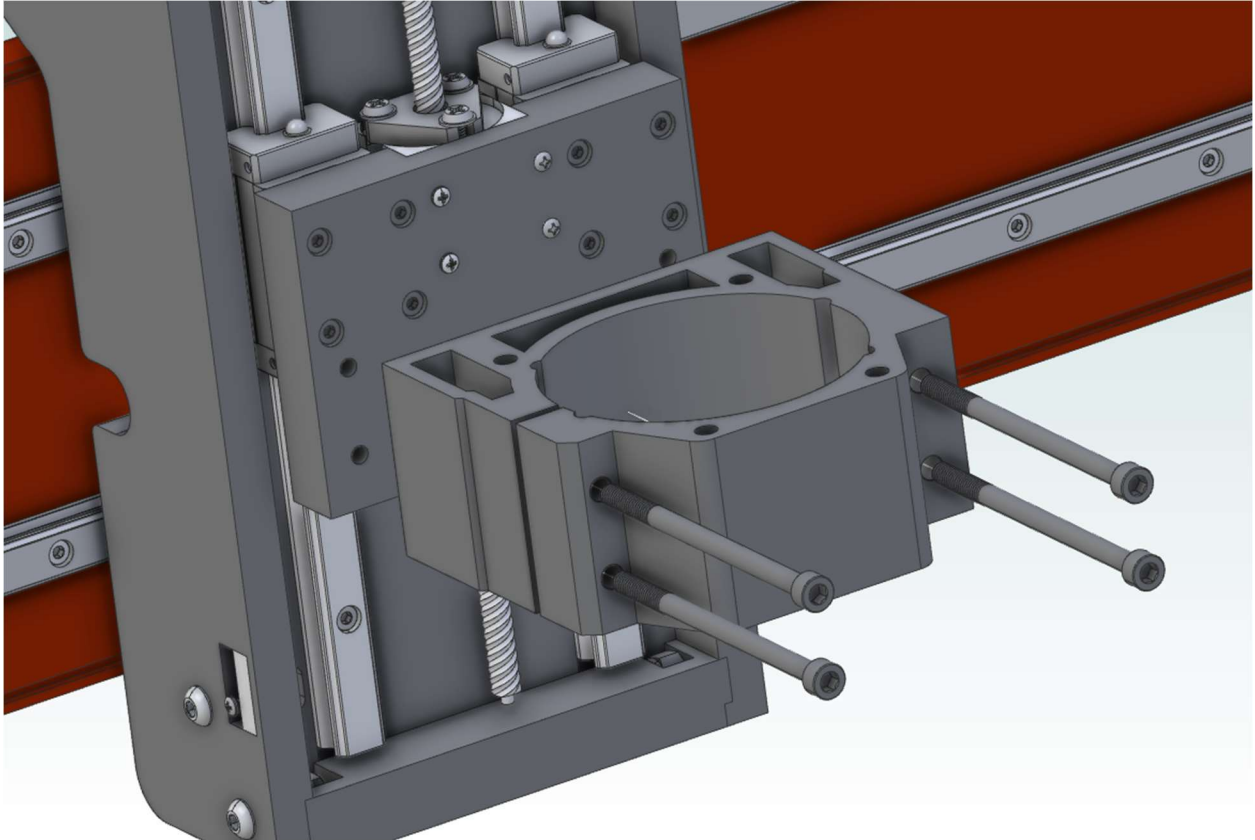

2. Loosen the 8 m4x18 bolts (it is recommended to use a hand tool for this to avoid stripping the bolts). Do not remove the bolts.

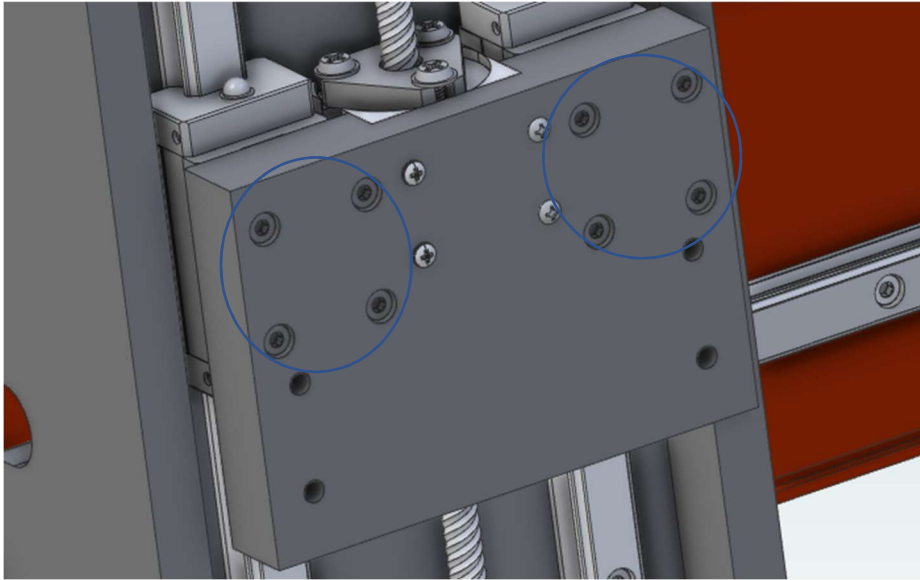

3. Square the Z bearing block to the bed of the machine using a carpenter's or machinist's square

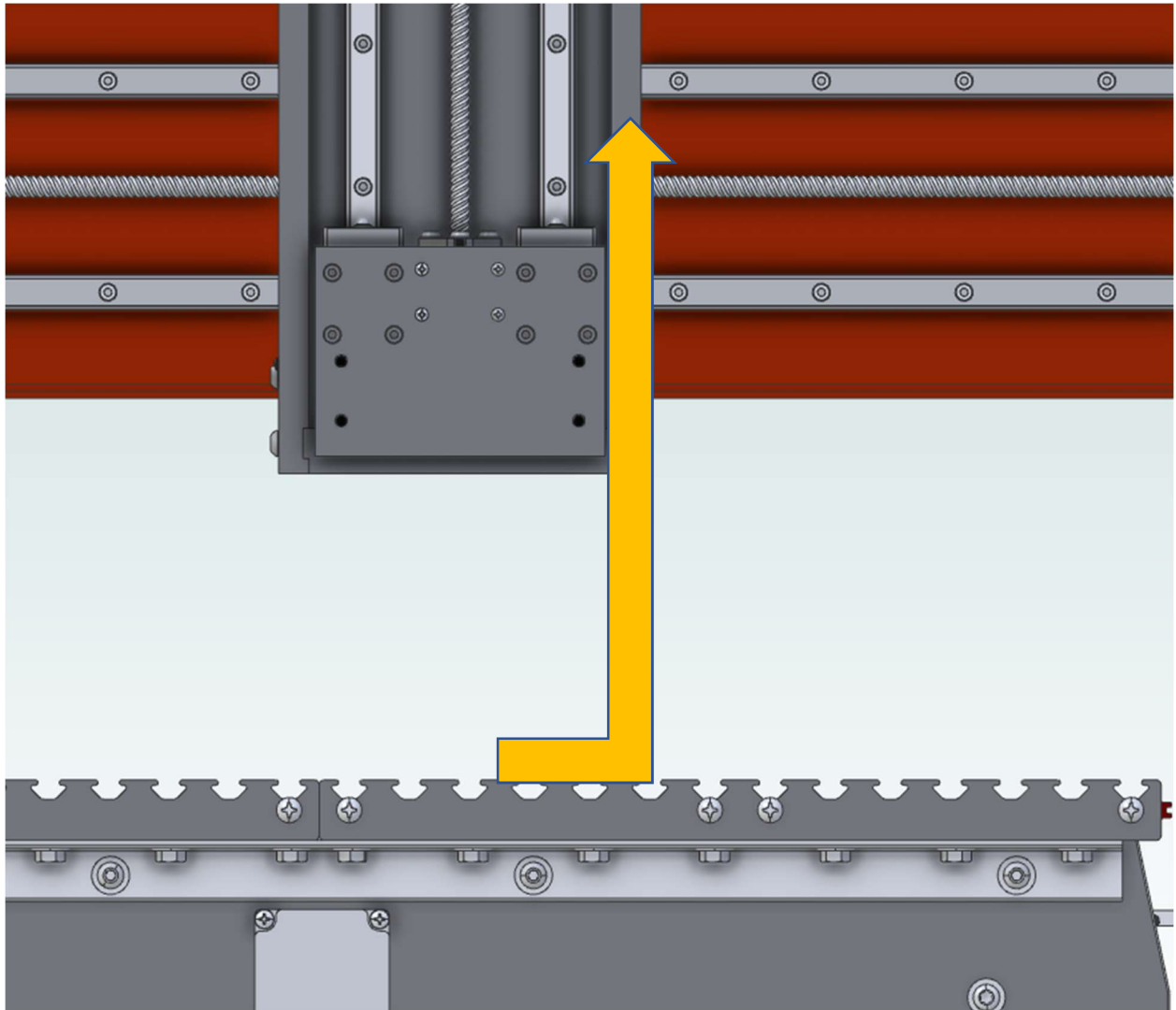

4. While holding the bearing block square, re-tighten the 8 m4 x 18 bolts.

Shimming the Aluminum Router Clamp

Loosen the four bolts attaching the router clamp to the bearing block, this will present a gap shown in the image below. Place a shim where desired, and simply re-tighten the 4 bolts when the clamp is in the desired position.

